

P.C.B MOUNTING

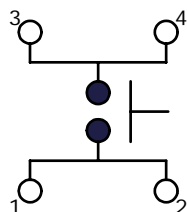

CIRCUIT: SPST

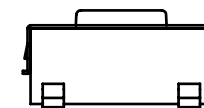
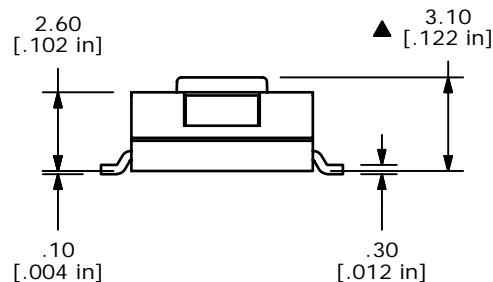
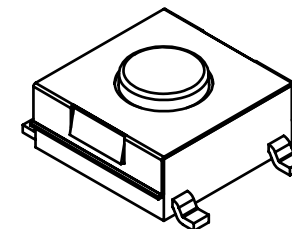
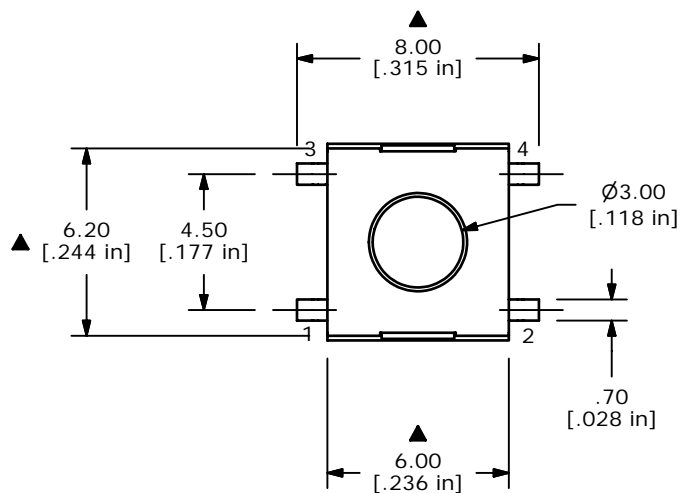

TERMINALS TO BE COPLANAR WITH IN 0.10mm

NOTES:

1. ALL DIMENSIONS IN MM [INCH]
2. GENERAL TOLERANCE: X.X=±0.4  
X.XX=±0.25
3. TERMINAL NUMBERS FOR REF ONLY.
4. TRAVEL: 0.25mm +0.2/-0.1
5. RATING: 50mA, 12VDC
- ▲ 6. OPERATING FORCE: 100± 50gf
7. CONTACT RESISTANCE: 100M OHM MAX.
- ▲ 8. ACTUATOR COLOR: BROWN
9. ▲DENOTES CRITICAL PARAMETER
- ▲10. PACKAGING: TAPE AND REEL 1,500 PCS PER
- ▲11. 2002/95/EC (ROHS) COMPLIANT

**E-SWITCH®**

D	16024	UPDATE ACTUATOR COLOR	5/16/06	CT
C	15915	REVISED REDRAWN	3/29/06	PH
REV	PCR NO	DESCRIPTION	DATE	BY

TITLE TL3303F100QG				
SCALE	DATE	DR	DWG	REV
4:1	3/29/2006	--	P010425	D

THE INFORMATION CONTAINED IN THIS DOCUMENT IS PROPRIETARY TO E-SWITCH AND IS NOT TO BE COPIED OR TRANSFERRED