

## DETAILS

<b>Product Number</b>	C13687_STRADA-SQ-T3
<b>Family</b>	Strada
<b>Type</b>	Lens
<b>Color</b>	clear
<b>Diameter</b>	25 x 25 mm
<b>Height</b>	8,2 mm
<b>Style</b>	square
<b>Optic Material</b>	PMMA
<b>Holder Material</b>	
<b>Fastening</b>	screw, pin, glue
<b>Status</b>	production ready
<b>ROHS Compliant</b>	Yes
<b>Date Updated</b>	17/01/2014



## OPTICAL PROPERTIES

LED	Viewing Angle	Light Beam	Efficiency	cd/lm	Connector
MK-R	Asymmetric deg	Asymmetric	94 %	0.480	-
XHP50	Asymmetric deg	Asymmetric	94 %	0.690	-
LUXEON M/MX	Asymmetric deg	Asymmetric	94 %	0.500	-
LUXEON MZ	asymmetric deg	Asymmetric	91 %	0.840	-
NFMW48xA	Asymmetric deg	Asymmetric	94 %	0.640	-
Duris S8	sim: Asymmetric	Asymmetric	sim: 91 %	-	-
Duris P10	sim: Asymmetric	Asymmetric	sim: 90 %	sim: 0.565	-

4

3

2

1

4

3

2

1

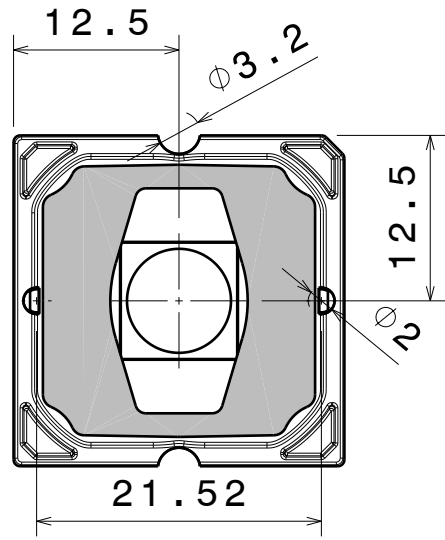

c / c Bottom view

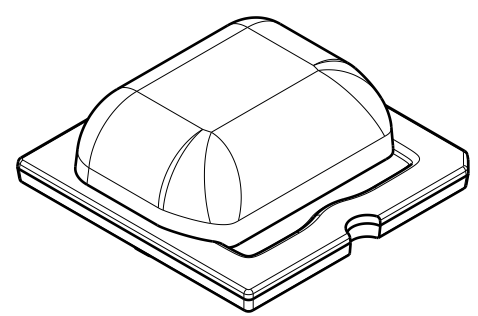

Isometric view

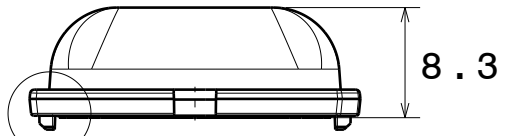

Front view

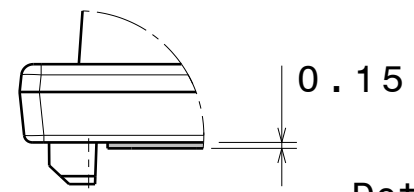

Detail B

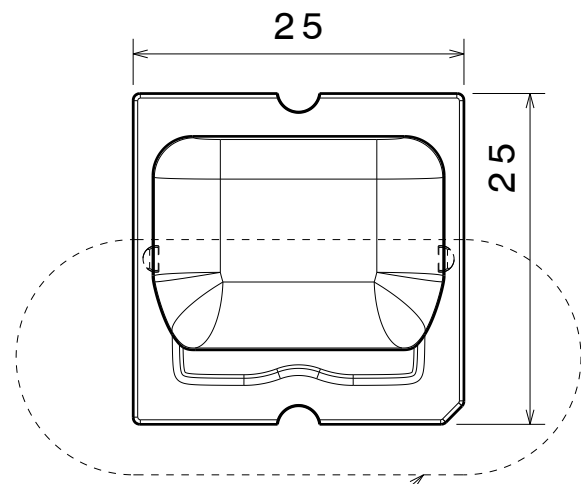

Beam direction Top view

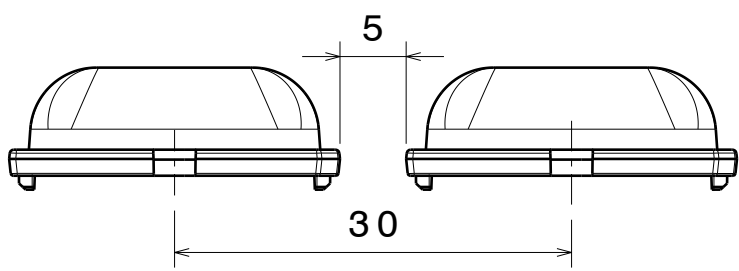

Minimum spacing c / c

Tolerances if not otherwise shown  
 According to DIN ISO 2768-1  
 Linear measures:  
 Up to 30mm class M, otherwise class C.  
 According to DIN ISO 2768-2  
 Form and position: class L



Ledil Oy  
 Salorankatu 10  
 FIN 24240 SALO  
 Finland

THIRD ANGLE PROJECTION:

DRAWING TITLE  
**STRADA-SQ-T3 Datasheet**

This drawing is the property of LEDiL Oy. It may not be reproduced, copied or communicated without a written agreement with LEDiL Oy."

SIZE	PART NUMBER
A4	-

SCALE	7:4	WEIGHT	-	SHEET	1/1
-------	-----	--------	---	-------	-----

D

A

Luminaire: LEDiL Oy C13687\_STRADA-SQ-T3\_(MK-R) Eff. 94 %  
Lamps: 1 x Cree MK-R 360lm@250mA

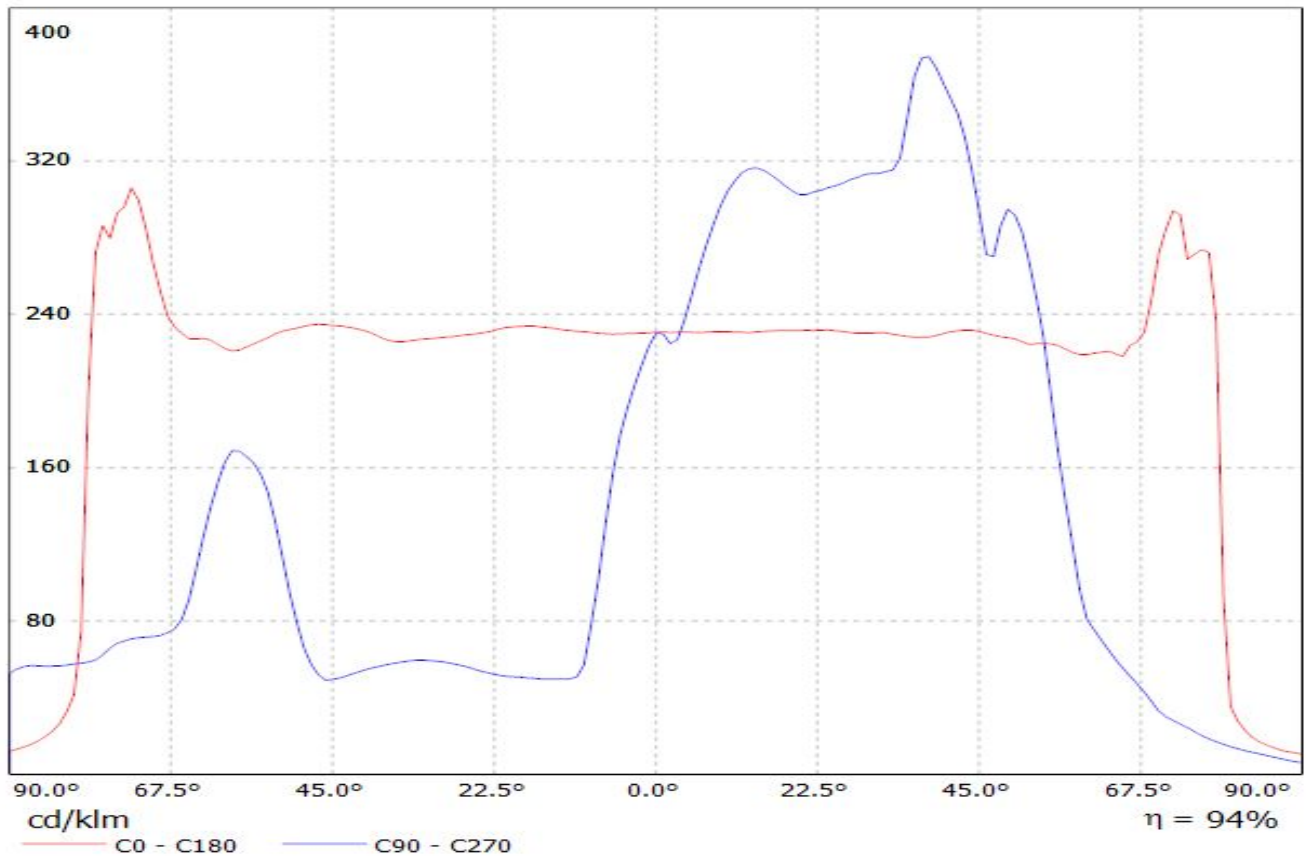

Luminaire: LEDiL Oy C13687\_STRADA-SQ-T3\_(Cree\_XHP50\_Cool\_White)  
Lamps: 1 x Cree\_XHP50\_Cool\_White\_244.145lm@250mA\_P=1.42855W\_l=0.2499A

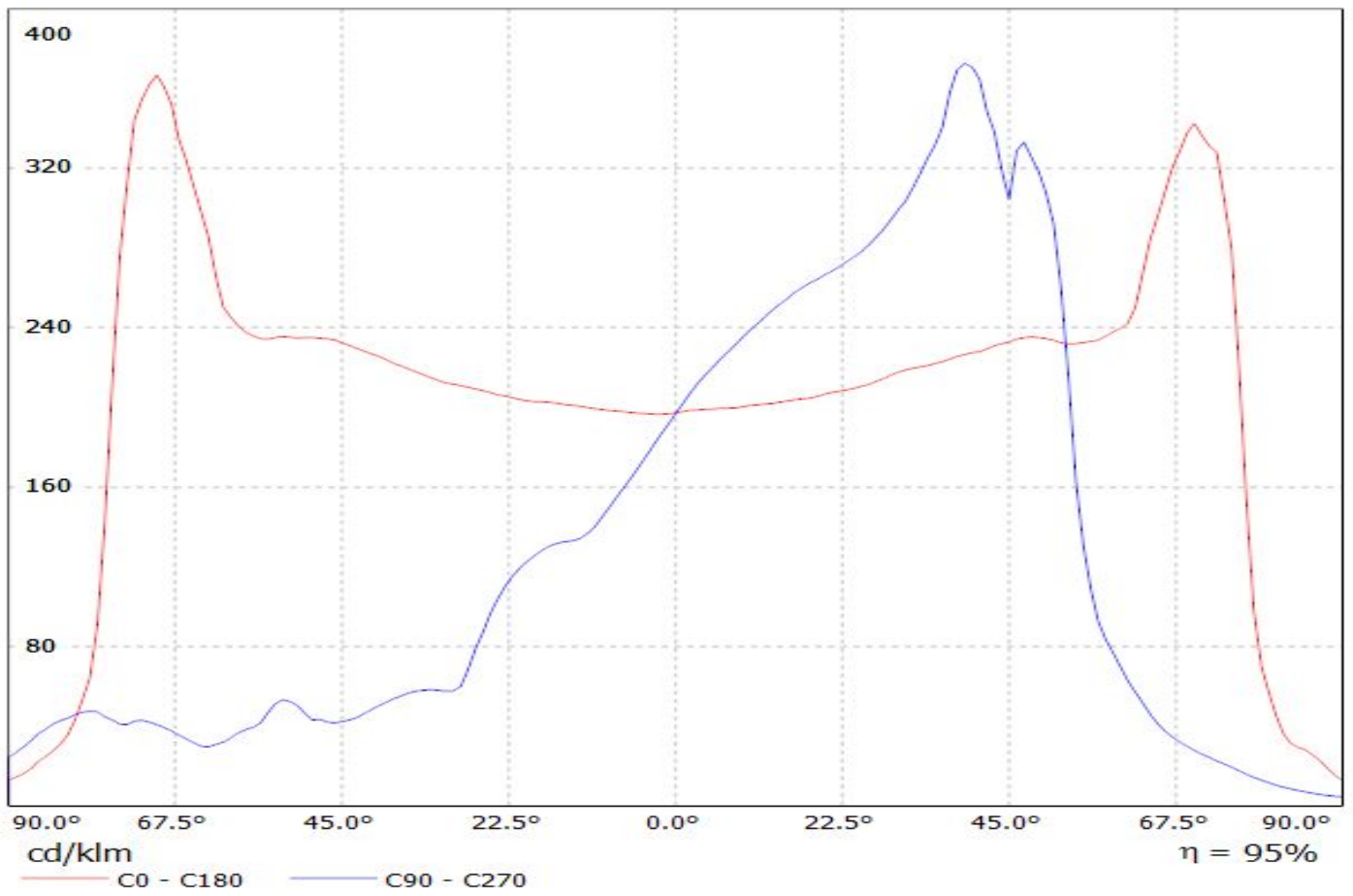

# LEDiL Oy C13687\_STRADA-SQ-T3\_(LUXEON\_M) Eff.93.9% / LDC (Linear)

Luminaire: LEDiL Oy C13687\_STRADA-SQ-T3\_(LUXEON\_M) Eff.93.9%

Lamps: 1 x LUXEON\_M\_348.959lm@250mA\_CCT=4092K\_P=2.72732W\_I=249.8mA

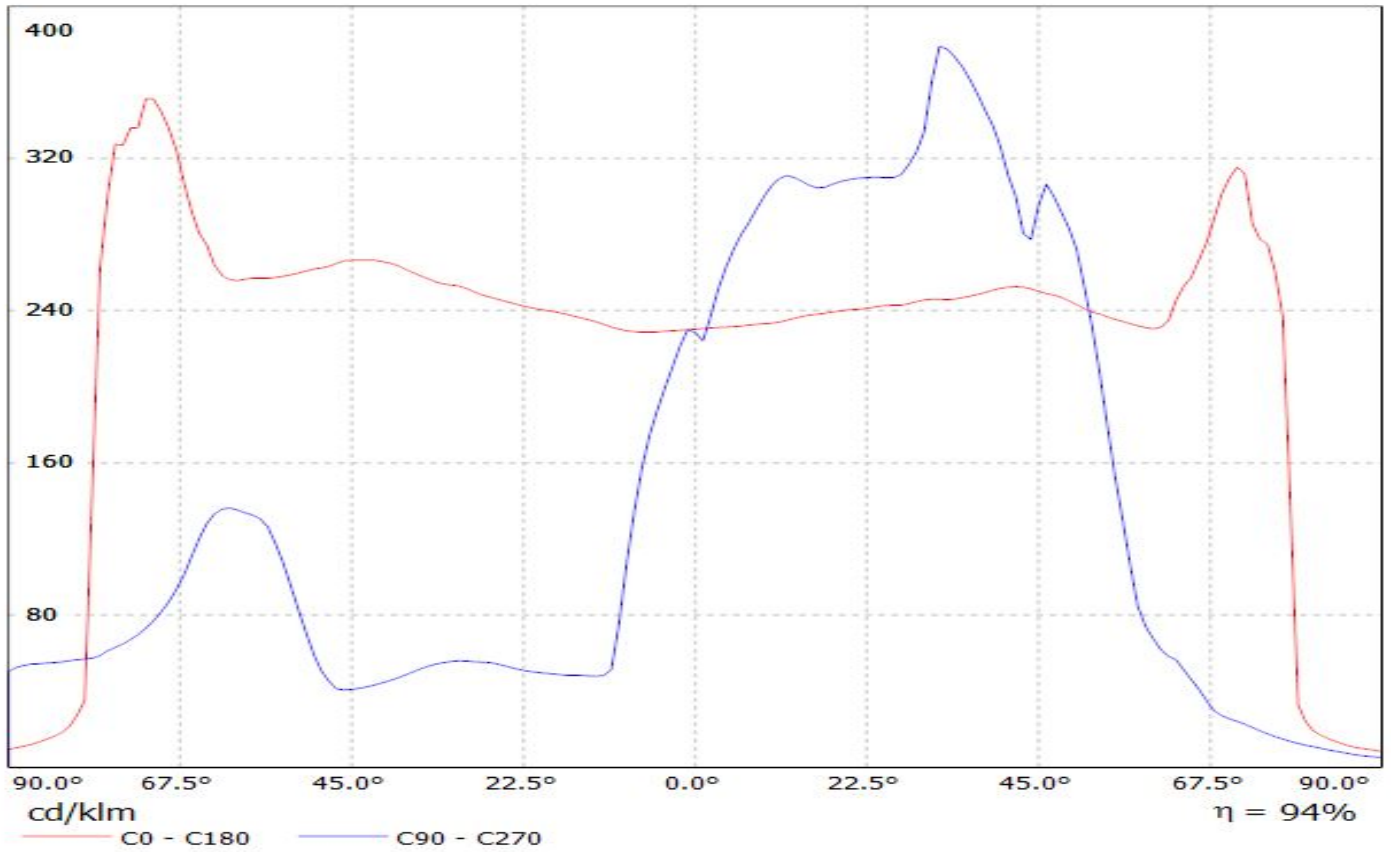

Luminaire: LEDiL Oy C13687\_STRADA-SQ-T3 (Luxeon\_MZ) Eff: 91%  
Lamps: 1 x LUXEON-MZ\_263.073lm@250mA\_P=2.7399W\_I=249.9mA

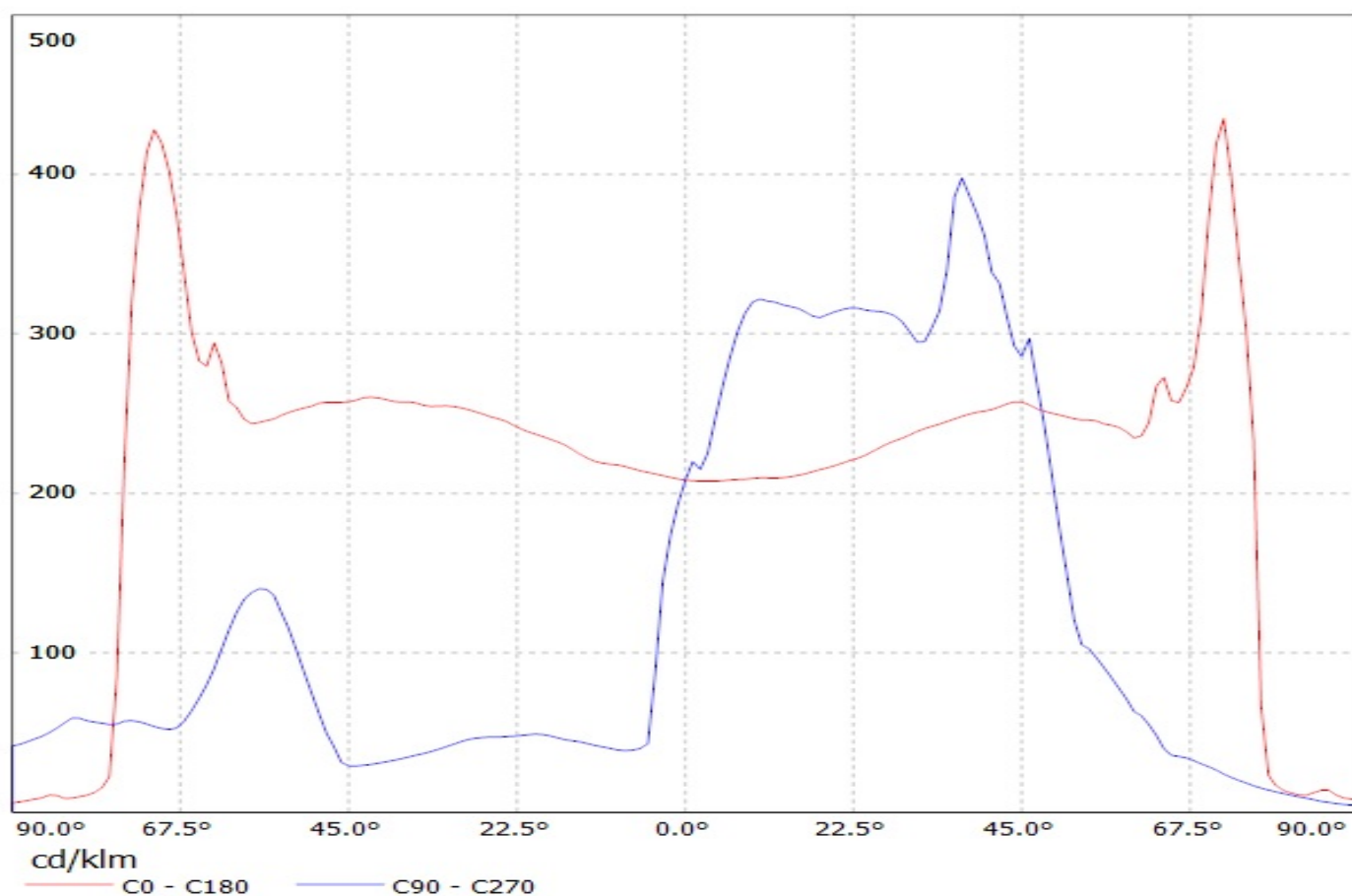

Luminaire: LEDiL Oy C13687\_STRADA-SQ-T3 (NFMx48xAR)

Lamps: 1 x Nichia\_NFMx48xAR\_(NFMW488AR)\_574.333lm@100mA\_P=4.0048W\_I=0.100A

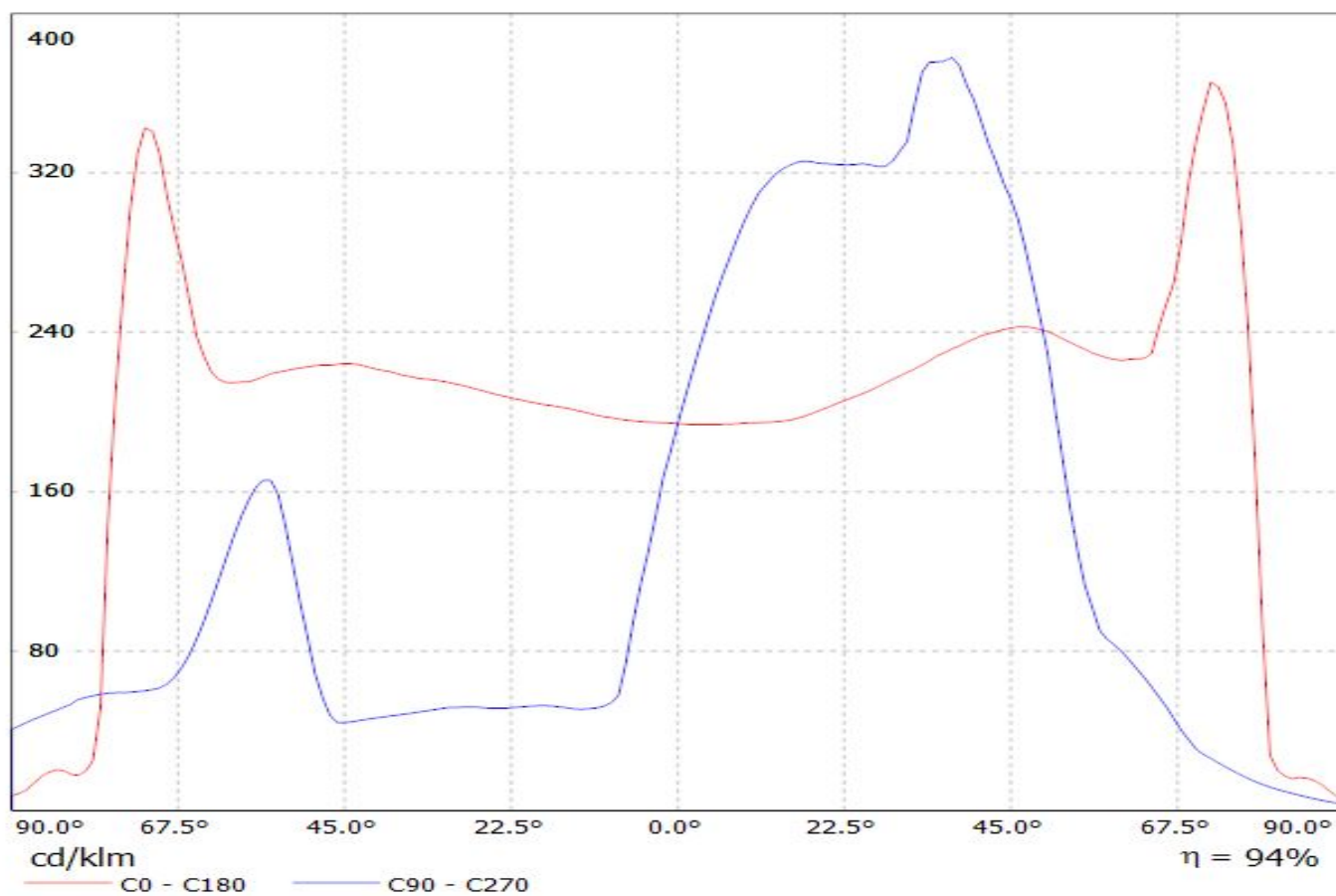

Luminaire: LEDiL Oy C13687\_STRADA-SQ-T3\_(MK-R) Eff. 94 %  
Lamps: 1 x Cree MK-R 360lm@250mA

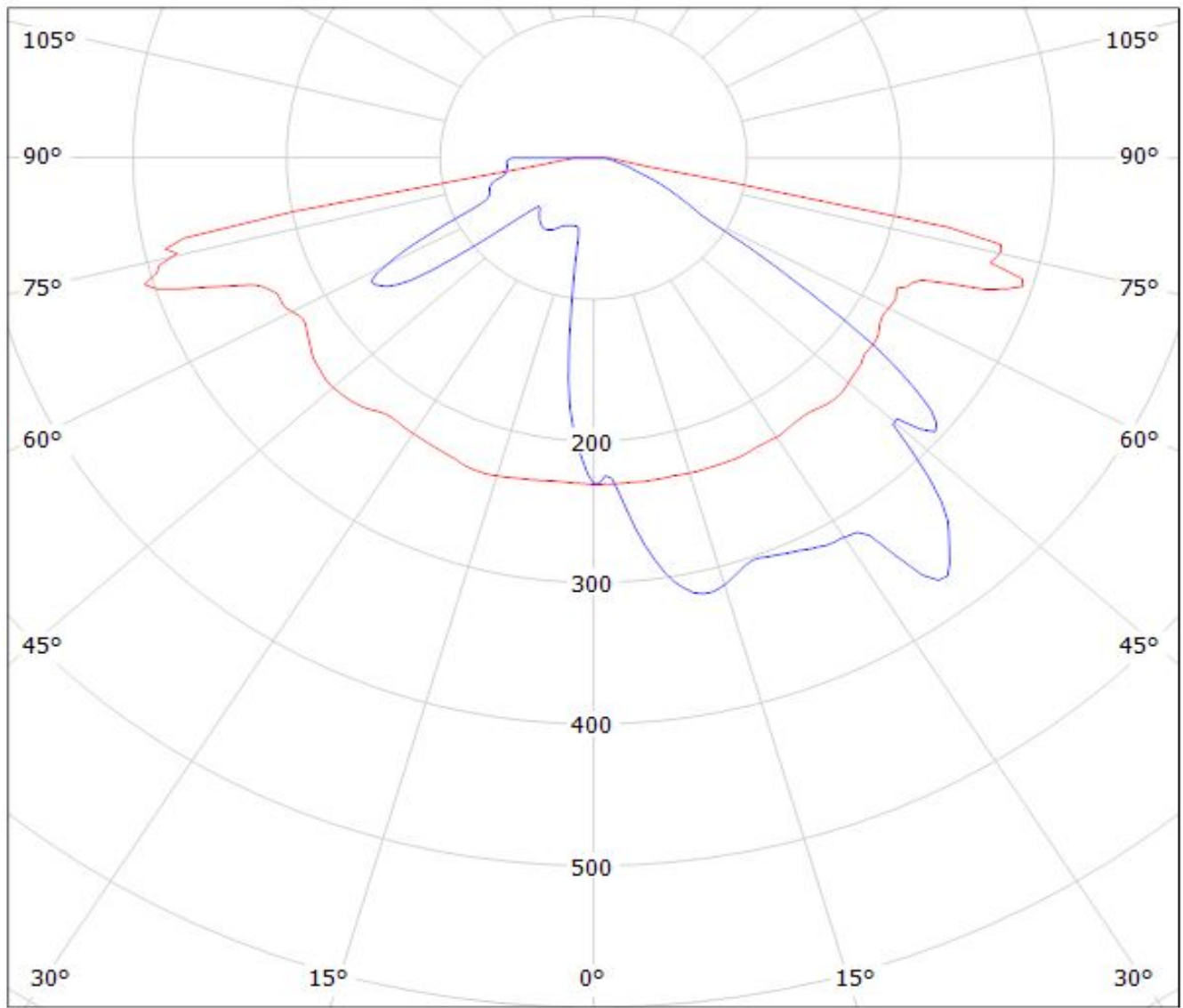

cd/klm

— C0 - C180

— C90 - C270

$\eta = 94\%$



Luminaire: LEDiL Oy C13687\_STRADA-SQ-T3\_(Cree\_XHP50\_Cool\_White)  
Lamps: 1 x Cree\_XHP50\_Cool\_White\_244.145lm@250mA\_P=1.42855W\_I=0.2499A

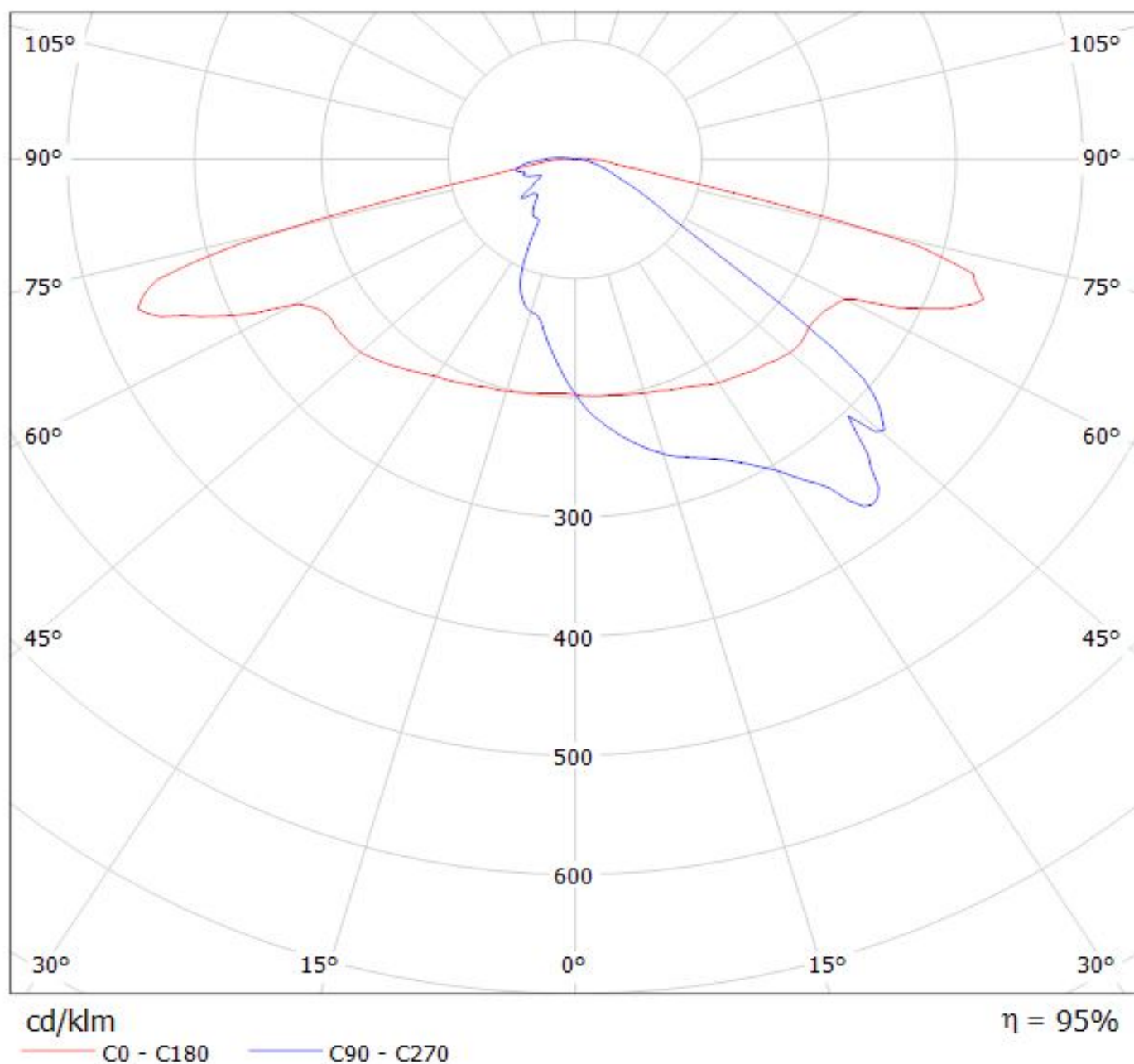

# LEDiL Oy C13687\_STRADA-SQ-T3\_(LUXEON\_M) Eff.93.9% / LDC (Polar)

Luminaire: LEDiL Oy C13687\_STRADA-SQ-T3\_(LUXEON\_M) Eff.93.9%

Lamps: 1 x LUXEON\_M\_348.959lm@250mA\_CCT=4092K\_P=2.72732W\_I=249.8mA

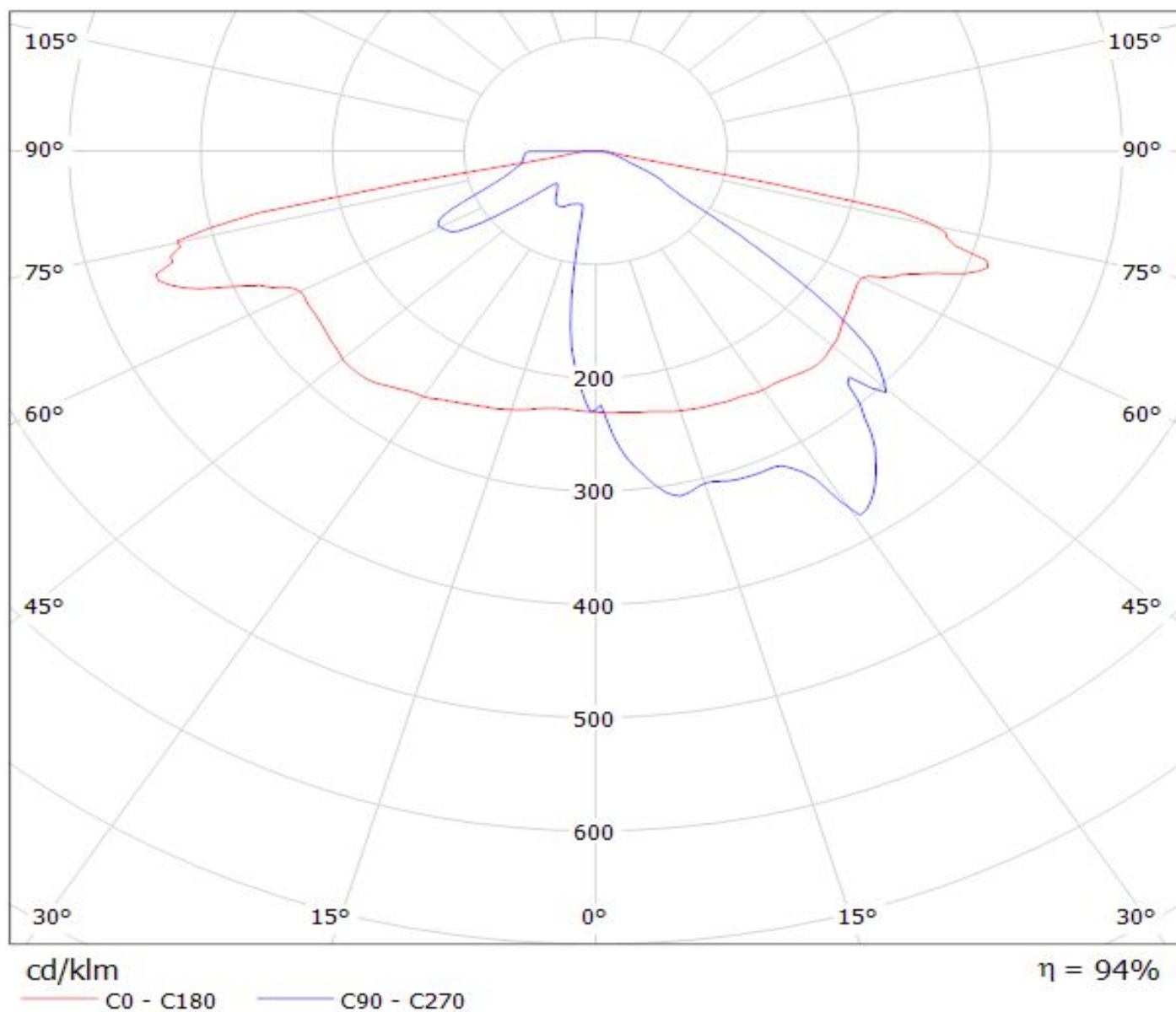

Luminaire: LEDiL Oy C13687\_STRADA-SQ-T3\_(Luxeon\_MZ) Eff: 91%  
Lamps: 1 x LUXEON-MZ\_263.073lm@250mA\_P=2.7399W\_I=249.9mA

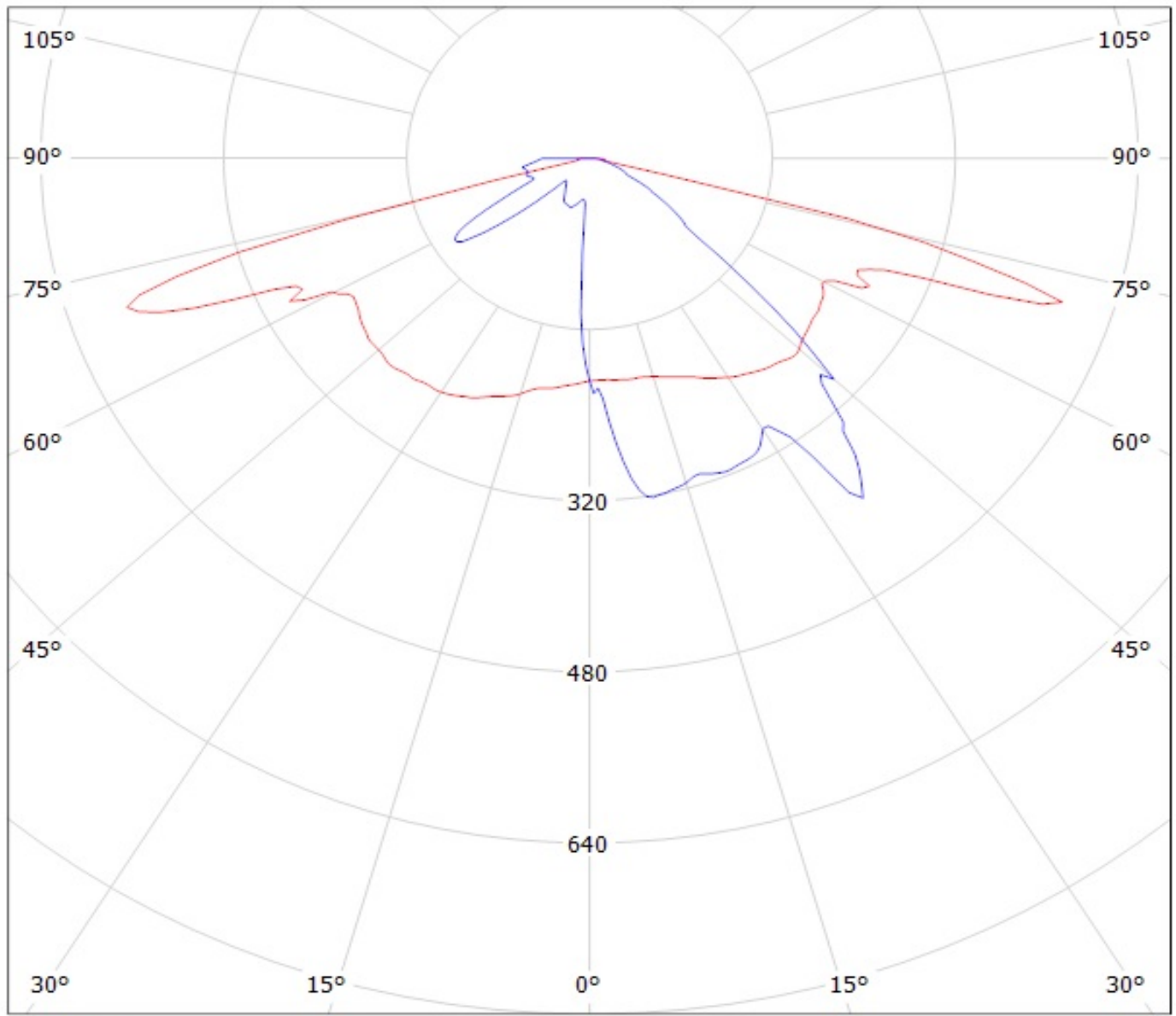

cd/klm

— C0 - C180    — C90 - C270

Luminaire: LEDiL Oy C13687\_STRADA-SQ-T3\_(NFMx48xAR)

Lamps: 1 x Nichia\_NFMx48xAR\_(NFMW488AR)\_574.333lm@100mA\_P=4.0048W\_I=0.100A

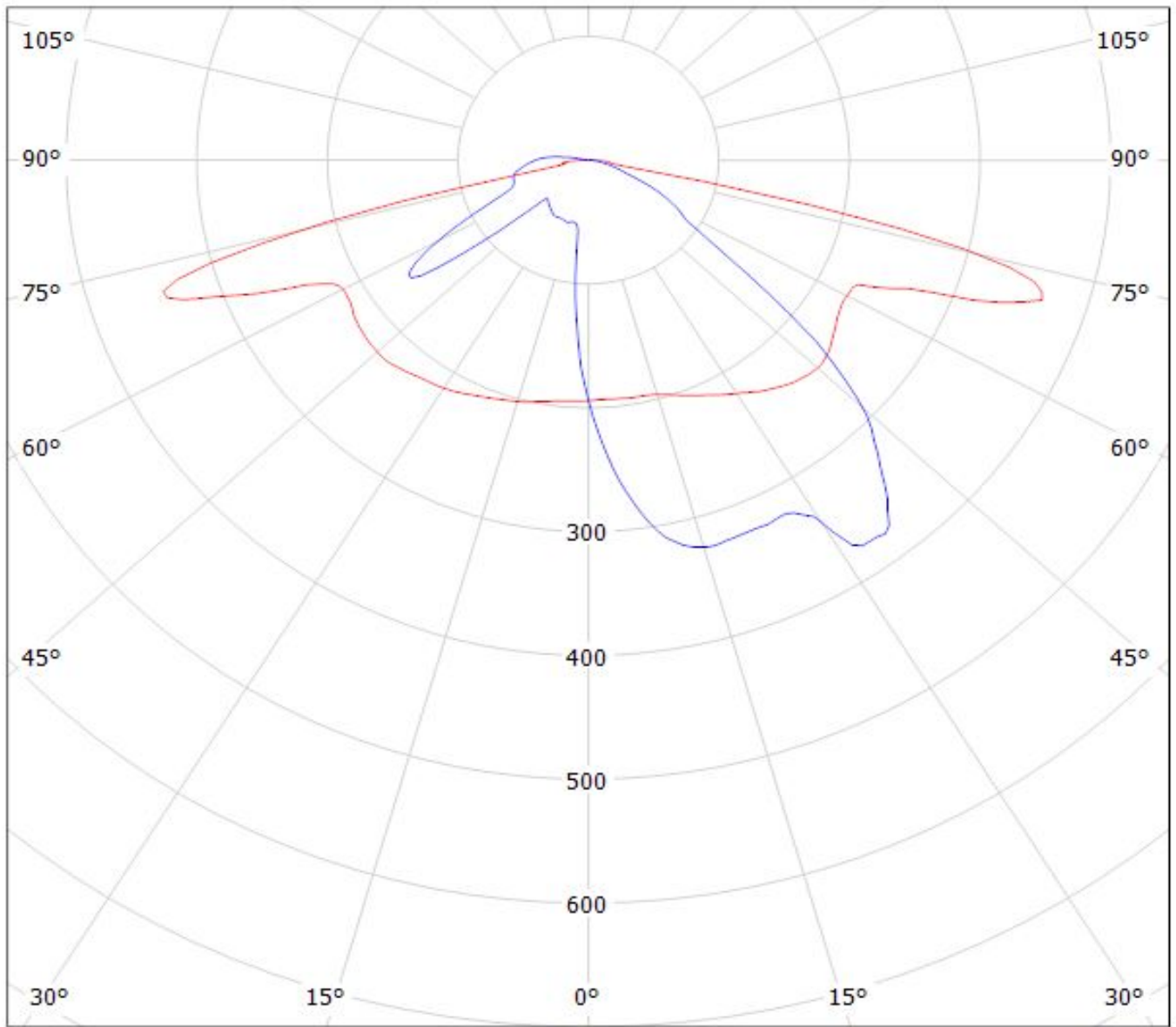

cd/klm  
— C0 - C180    — C90 - C270

$\eta = 94\%$

**NOTE: The typical divergence will be changed by different color, chip size and chip position tolerance. The typical total divergence is the full angle measured where the luminous intensity is half of the peak value.**