

THIS DRAWING AND THE INFORMATION SET FORTH HEREON ARE THE PROPERTY OF TYCO ELECTRONICS CORPORATION AND ARE TO BE HELD IN TRUST AND CONFIDENCE. PUBLICATION, DUPLICATION, DISCLOSURE OR USE FOR ANY PURPOSE NOT EXPRESSLY AUTHORIZED IN WRITING BY TYCO ELECTRONICS CORPORATION IS PROHIBITED.

REVISION			
REV	DESCRIPTION	DATE	APPROVED
A	INITIAL RELEASE PER DCR# R050477	DEC/12/05	M.HIGGY

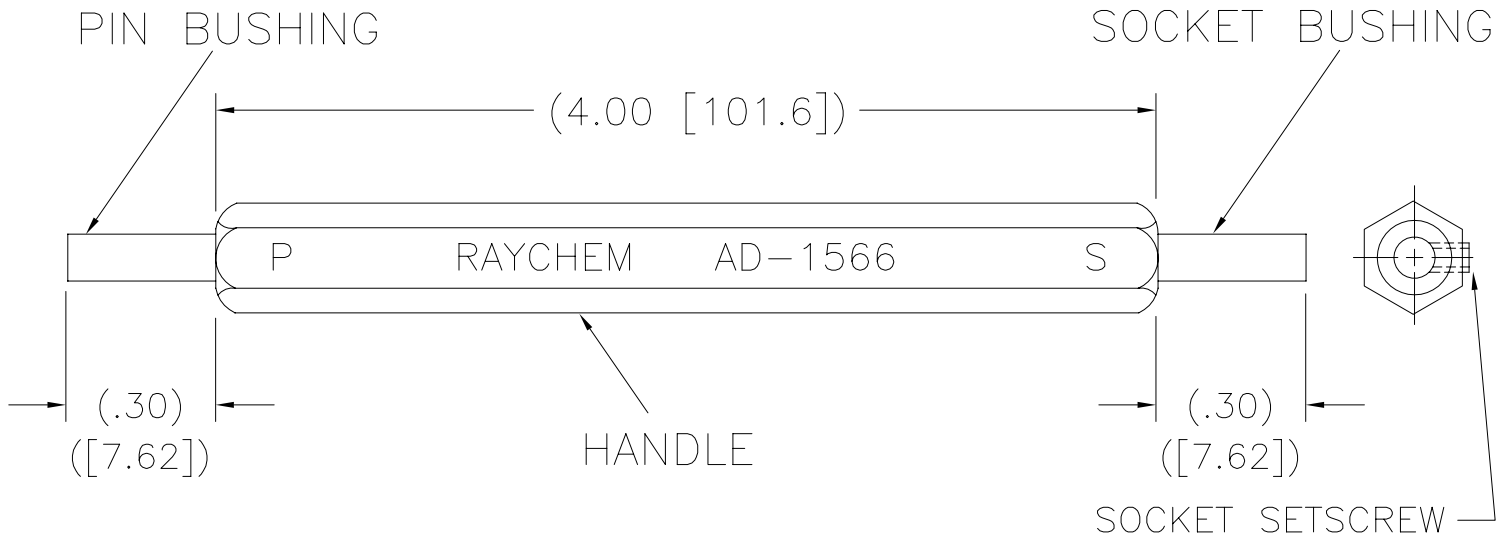

NOTES:

- FOR TERMINATION INSTRUCTIONS AND APPLICATIONS SEE ENGINEERING STANDARD ( ES-61206 ).
- MATERIAL: HANDLE: HEX ALUMINUM 6061-T651 PER ASTM B221, FINISH: CLEAR ANODIZED  
PIN AND SOCKET BUSHING:  
HOUSING: 303 STAINLESS STEEL PER ASTM A484  
INNER STOP: BRASS 360 1/2 HARD PER ASTM B16/16M  
SCREW: 4-40 UNC-2B SOCKET SETSCREW, STAINLESS STEEL

If this document is printed it becomes uncontrolled.  
 Check for the latest revision.

SPECIFICATION CONTROL DRAWING

© 2005 Tyco Electronics Corporation.  
 All rights reserved

ITEM	QTY.	PART NO	DWG OR SPEC NO	DESCRIPTION
PARTS LIST				
UNLESS OTHERWISE SPECIFIED DIMENSIONS ARE INCHES. METRIC DIMENSIONS ARE IN BRACKETS.		DRAWN ZS.ORBAN	DATE DEC/6/05	 TYCO ELECTRONICS 300 Constitution Drive Menlo Park, CA. 94025 USA 
DECIMAL TOLERANCES .XXX ± .005 [ .13 mm] .XX ± .01 [ .25 mm] .X ± [ mm]		APPROVED M.HIGGY	DATE DEC/6/05	
ANGLE TOLERANCE .X ±		REPAIR HOLDING FIXTURE		
WEIGHT				
CAD FILE R050477.DWG		THIRD ANGLE PROJECTION		SIZE A CAGE CODE: 06090 DWG. NO. AD-1566 A
DO NOT SCALE THIS DRAWING				SHEET 1 OF 1