

DETAILS

Product Number	C13254_HELENA-B
Family	Helena
Type	Lens
Color	clear
Diameter	72,8 mm
Height	11,1 mm
Style	round
Optic Material	PC
Holder Material	
Fastening	
Status	production ready
ROHS Compliant	Yes
Date Updated	27/02/2013



OPTICAL PROPERTIES

LED	Viewing	Light	Effi-	cd/lm	Connector
	Angle	Beam	ciency		
CXA/B 15xx	21 deg	Medium	74 %	3.100	-
CXA/B 25xx	31 deg	Medium	75 %	1.600	-
LUXEON K16	27 deg	Medium	74 %	1.730	-
LUXEON K12	24 deg	Medium	74 %	2.100	-
LUXEON K8	23 deg	Medium	75 %	2.550	-

D

C

B

A

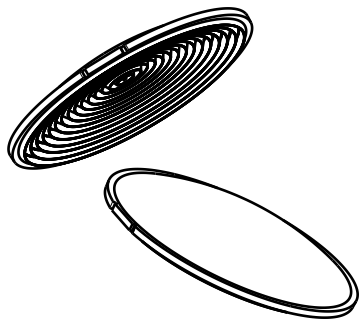

Isometric view
Scale: 1:2

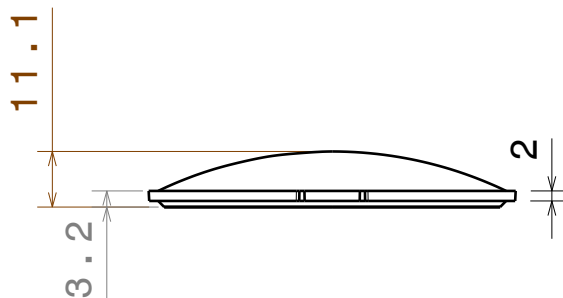

Front view

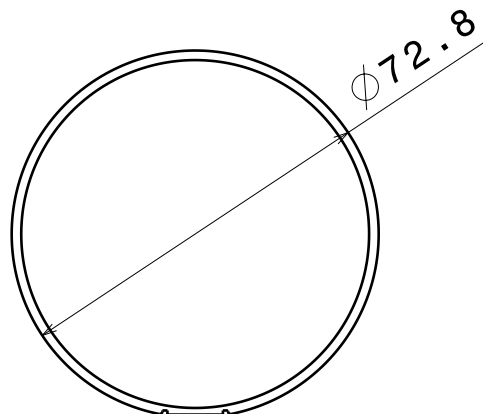

Top view

Tolerances for dimensions:
 0-20mm tolerance value $\pm 0.1\text{mm}$
 21-45mm tolerance value $\pm 0.2\text{mm}$
 46-90mm tolerance value $\pm 0.3\text{mm}$
 91-100mm tolerance value $\pm 0.4\text{mm}$
 101-mm tolerance value $\pm 0.5\text{mm}$

This drawing is our property.
 It can't be reproduced
 or communicated without
 our written agreement.



Ledil Oy
 Salorankatu 10
 FIN 24240 SALO
 Finland

DRAWING TITLE
 Datasheet C13254_HELENA-B Lens

DRAWN BY		DATE		DRAWING NUMBER				REV	
CHECKED BY		DATE		C13254		1			
DESIGNED BY		DATE		SCALE 1:1		WEIGHT (g)		SHEET 1/1	

D

A

4

4

3

3

2

2

1

1

Ledil C13254_HELENA_B_(CXA1520) / LDC (Linear)

Luminaire: Ledil C13254_HELENA_B_(CXA1520)
Lamps: 1 x Cree_CXA1520_(CXA1520-30F-N4-N0H-0001)
_1011.67lm@250mA_CCT=3094K_P=8.421W_I=0.25A

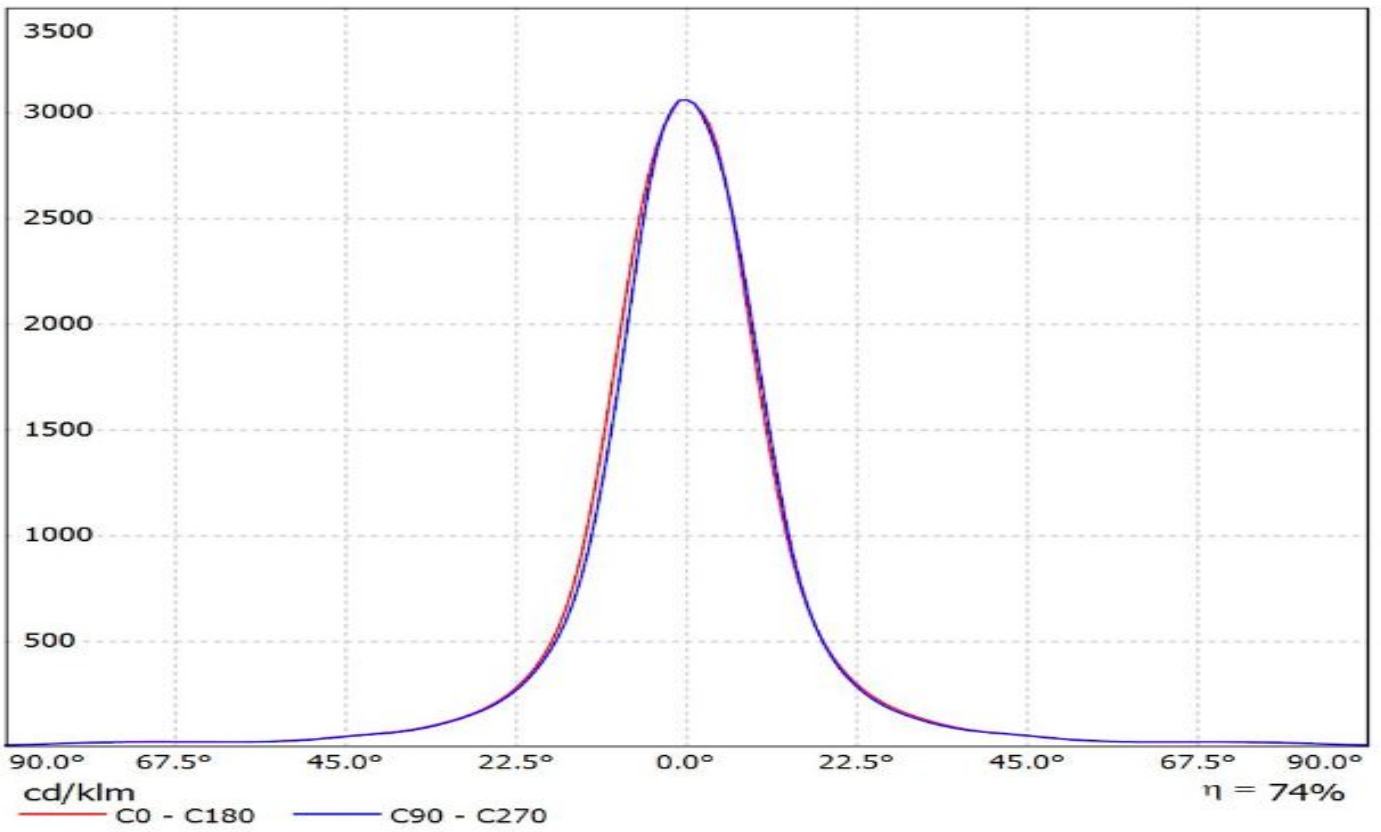

Ledil C13254_HELENA_B_(CXA2520) / LDC (Linear)

Luminaire: Ledil C13254_HELENA_B_(CXA2520)

Lamps: 1 x Cree_CXA2520_(CXA2520-7A-N4-N0U)_878.87lm@250mA_CCT=3000K_P=8.5063W_I=0.25A

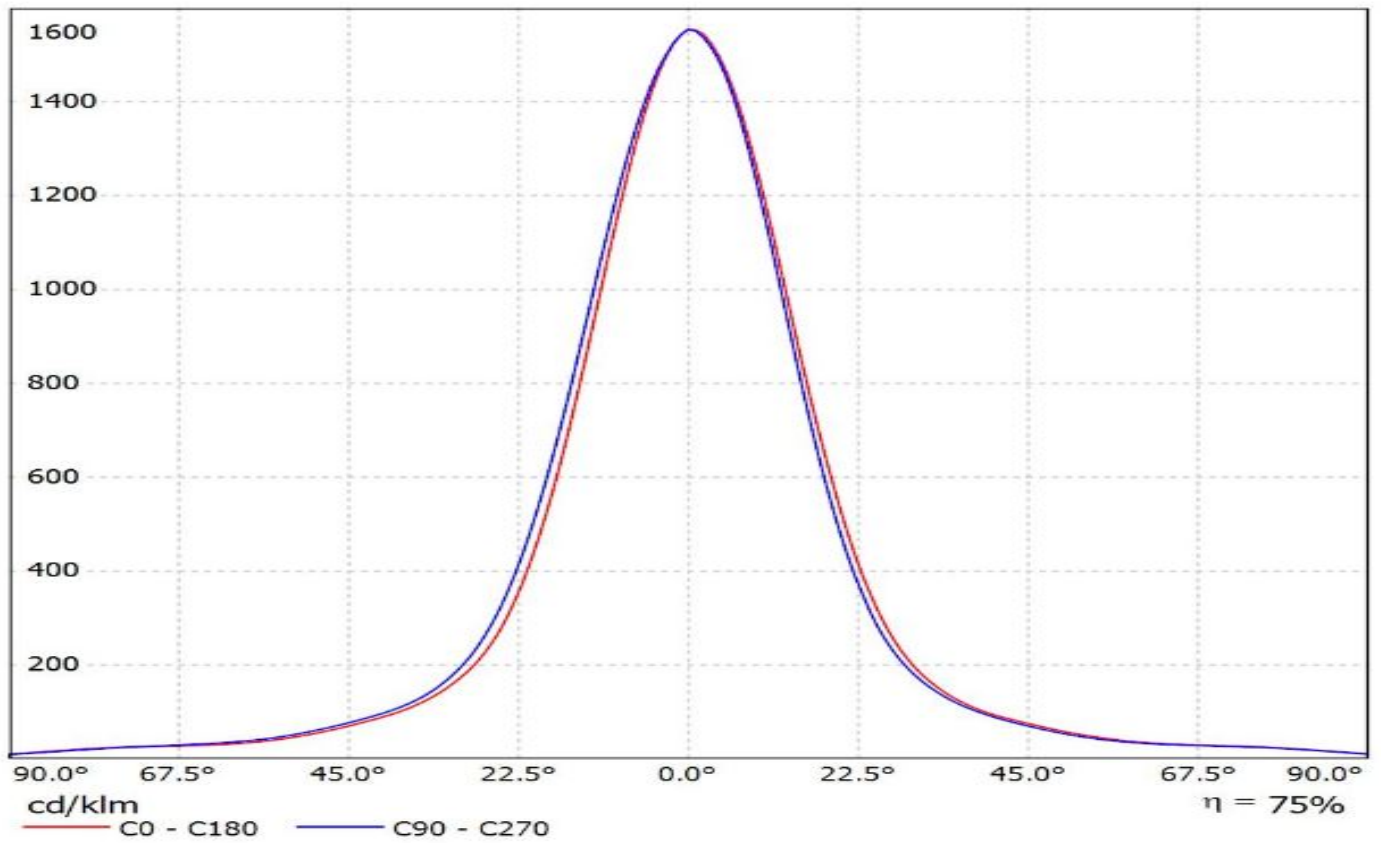

Luminaire: LEDiL Oy C13254_HELENA-B_(LUXEON_K16) Eff.73.6%
Lamps: 1 x LUXEON K16 (1196.37lm@250mA)

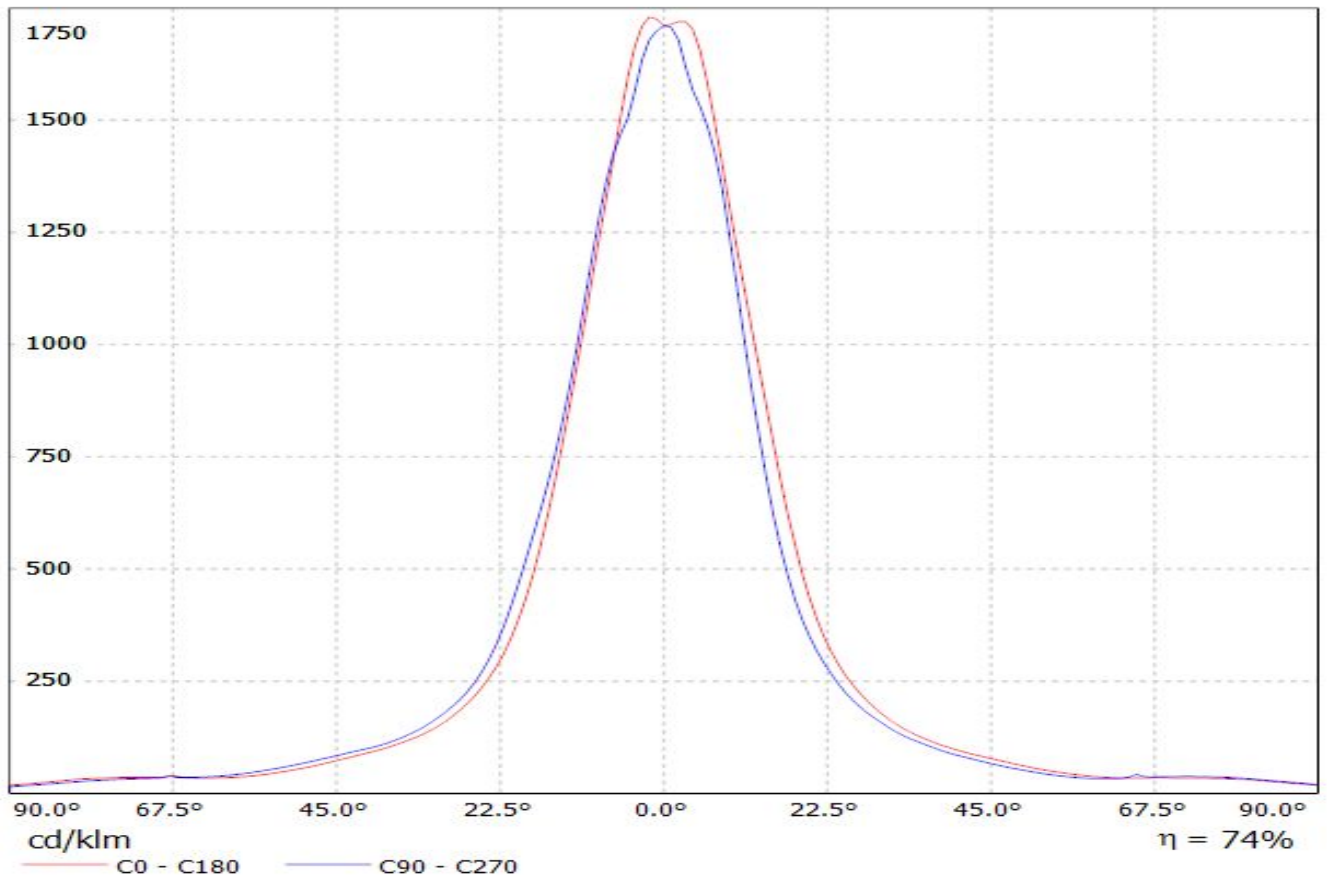

Luminaire: LEDiL Oy C13254_HELENA-B_(Luxeon_K12) Eff. 73,7%

Lamps: 1 x Luxeon K12 (797lm@250mA)

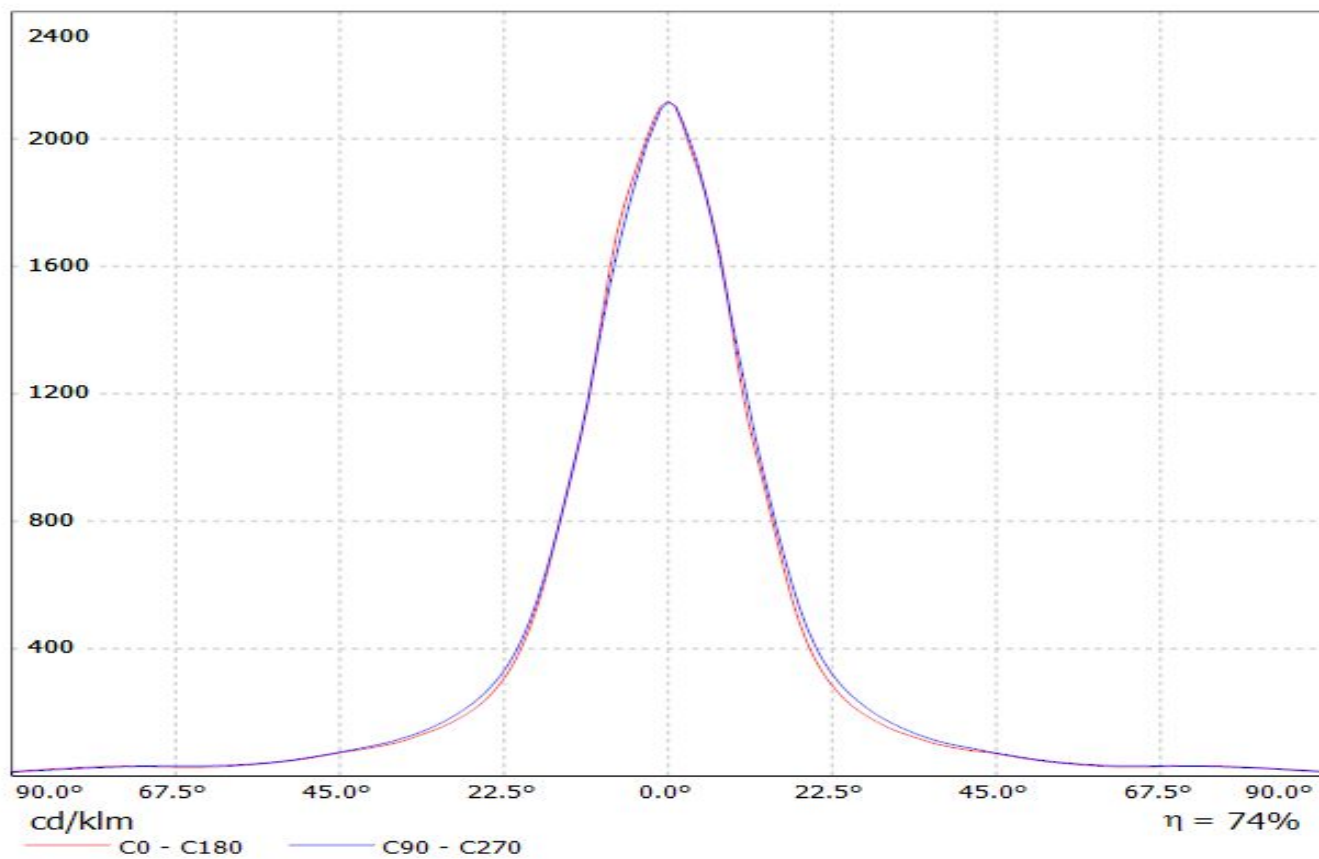

Luminaire: LEDiL Oy C13254_HELENA-B_(Luxeon_K8) Eff. 75,1%
Lamps: 1 x Luxeon K8 (609lm@250mA)

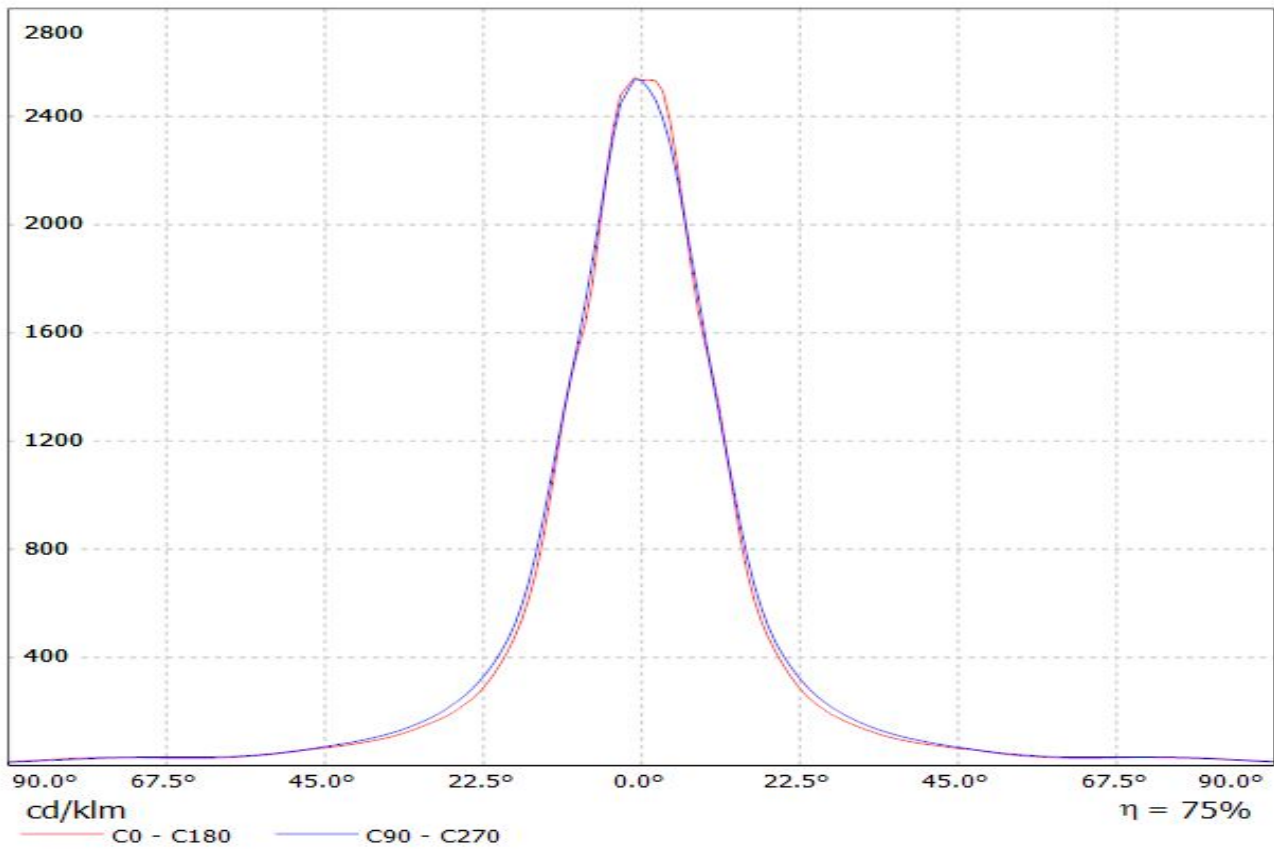

Ledil C13254_HELENA_B_(CXA1520) / LDC (Polar)

Luminaire: Ledil C13254_HELENA_B_(CXA1520)
Lamps: 1 x Cree_CXA1520_(CXA1520-30F-N4-N0H-0001)
_1011.67lm@250mA_CCT=3094K_P=8.421W_I=0.25A

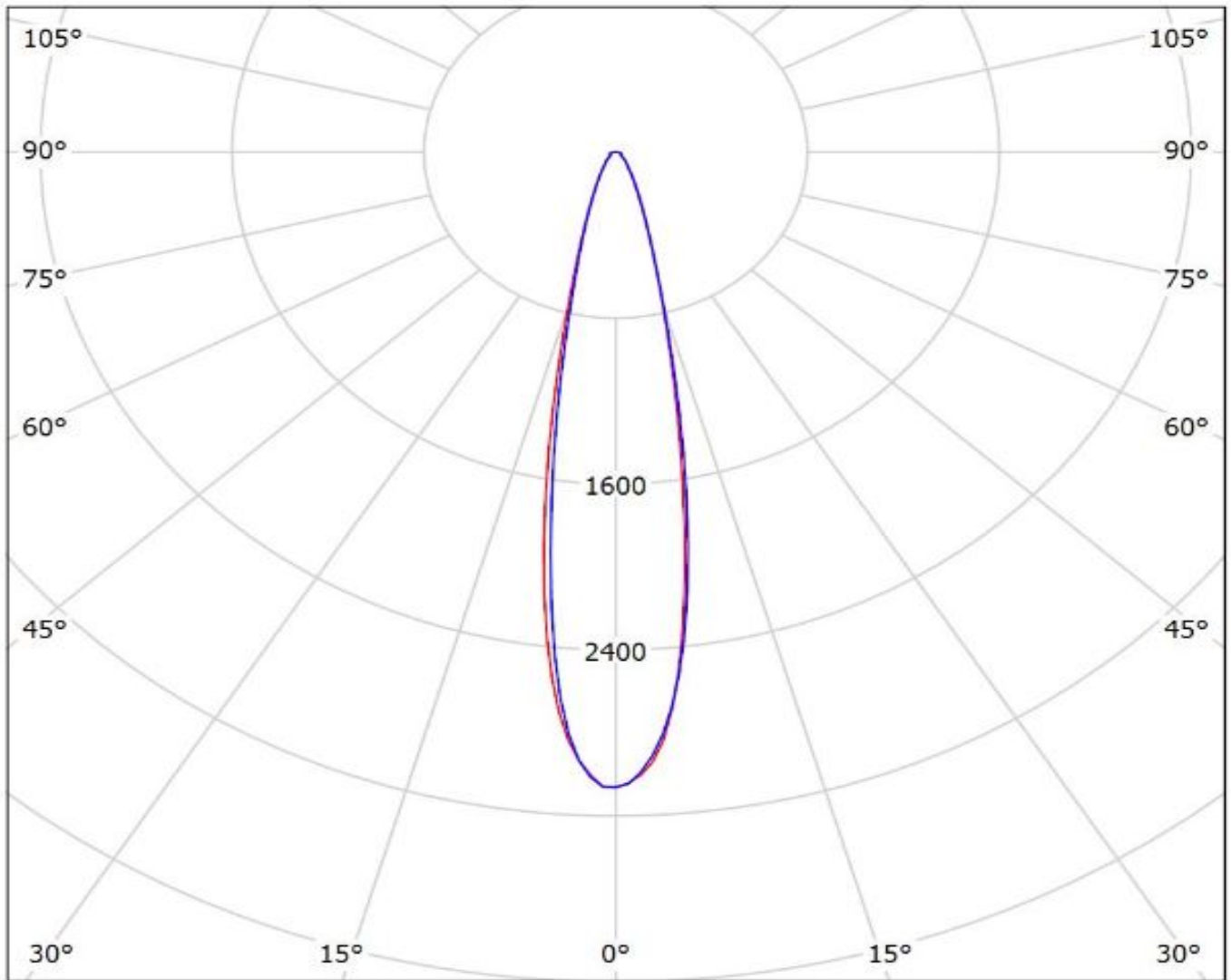

cd/klm
— C0 - C180 — C90 - C270

$\eta = 74\%$

Ledil C13254_HELENA_B_(CXA2520) / LDC (Polar)

Luminaire: Ledil C13254_HELENA_B_(CXA2520)

Lamps: 1 x Cree_CXA2520_(CXA2520-7A-N4-N0U)_878.87lm@250mA_CCT=3000K_P=8.5063W_I=0.25A

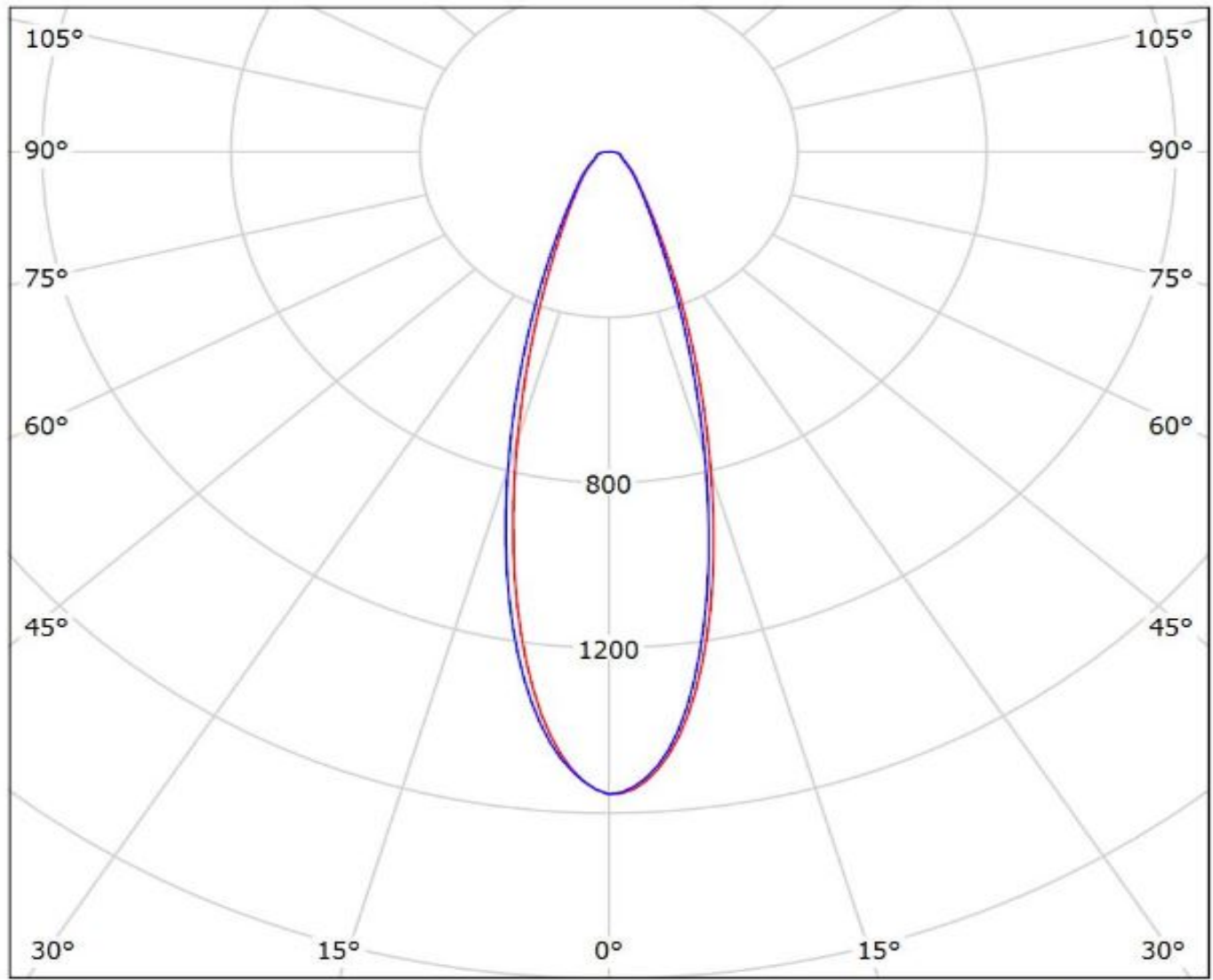

cd/klm

— C0 - C180

— C90 - C270

$\eta = 75\%$

Luminaire: LEDiL Oy C13254_HELENA-B_(LUXEON_K16) Eff.73.6%
Lamps: 1 x LUXEON K16 (1196.37lm@250mA)

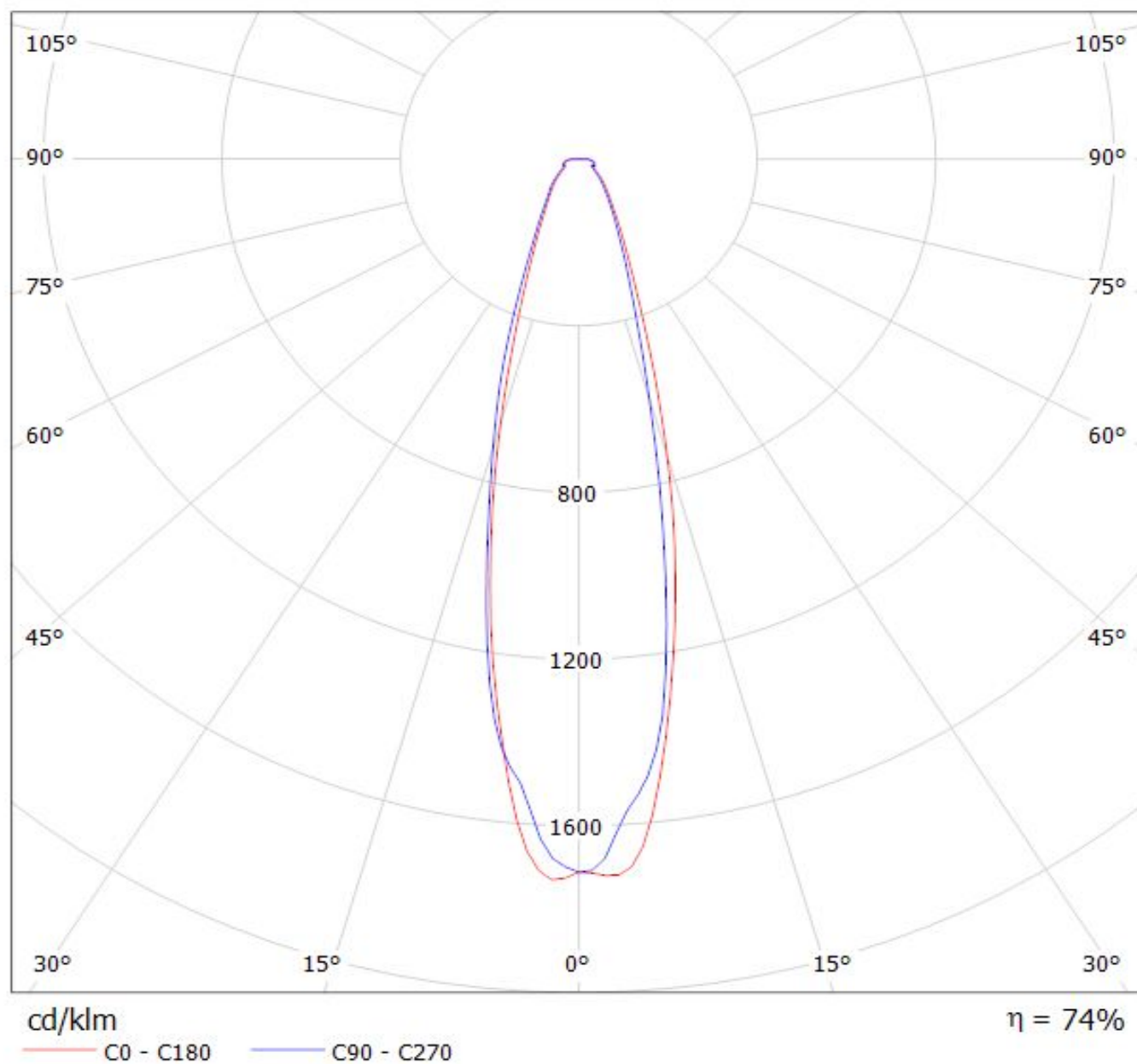

Luminaire: LEDiL Oy C13254_HELENA-B_(Luxeon_K12) Eff. 73,7%
Lamps: 1 x Luxeon K12 (797lm@250mA)

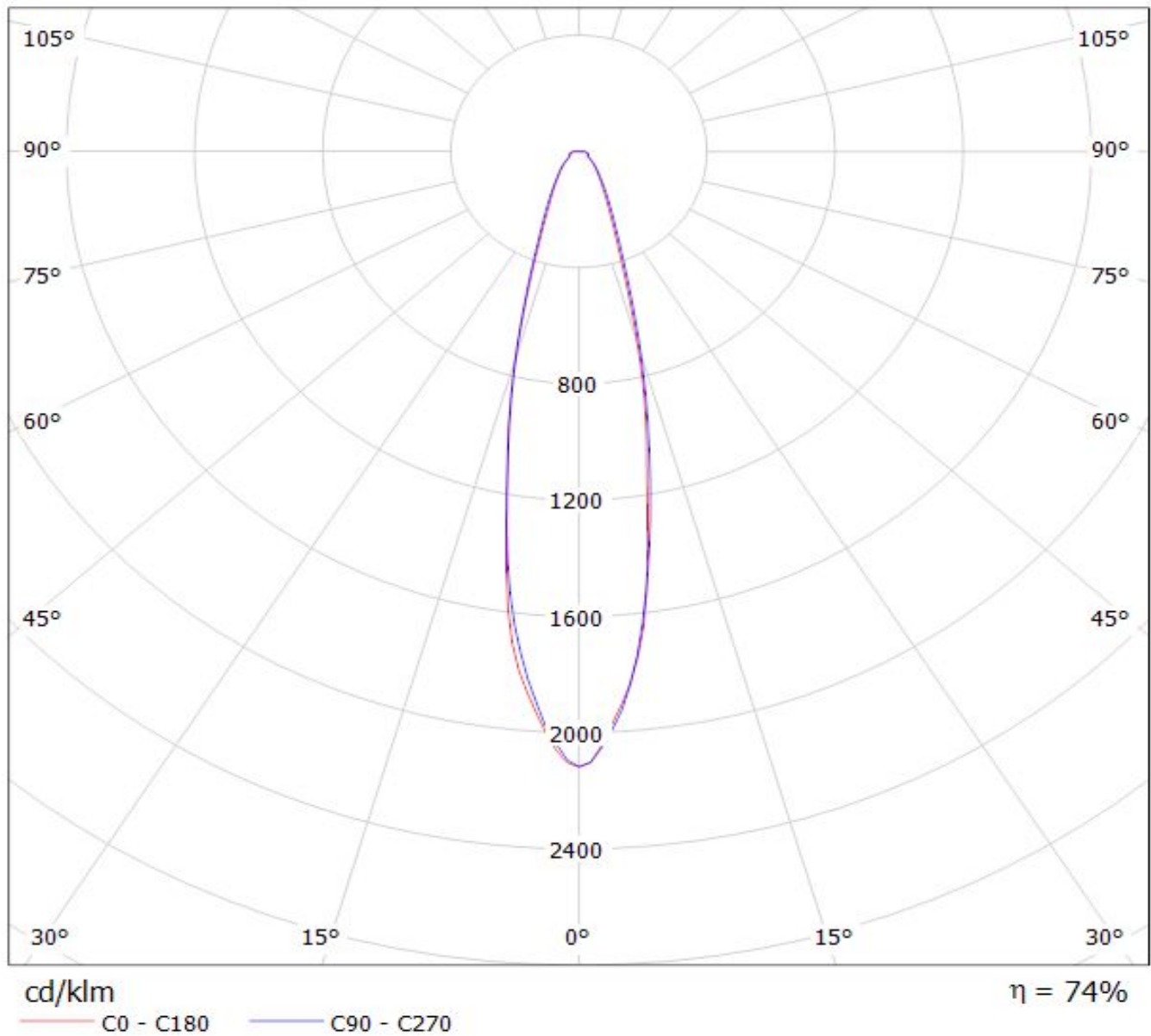

Luminaire: LEDiL Oy C13254_HELENA-B_(Luxeon_K8) Eff. 75,1%
Lamps: 1 x Luxeon K8 (609lm@250mA)

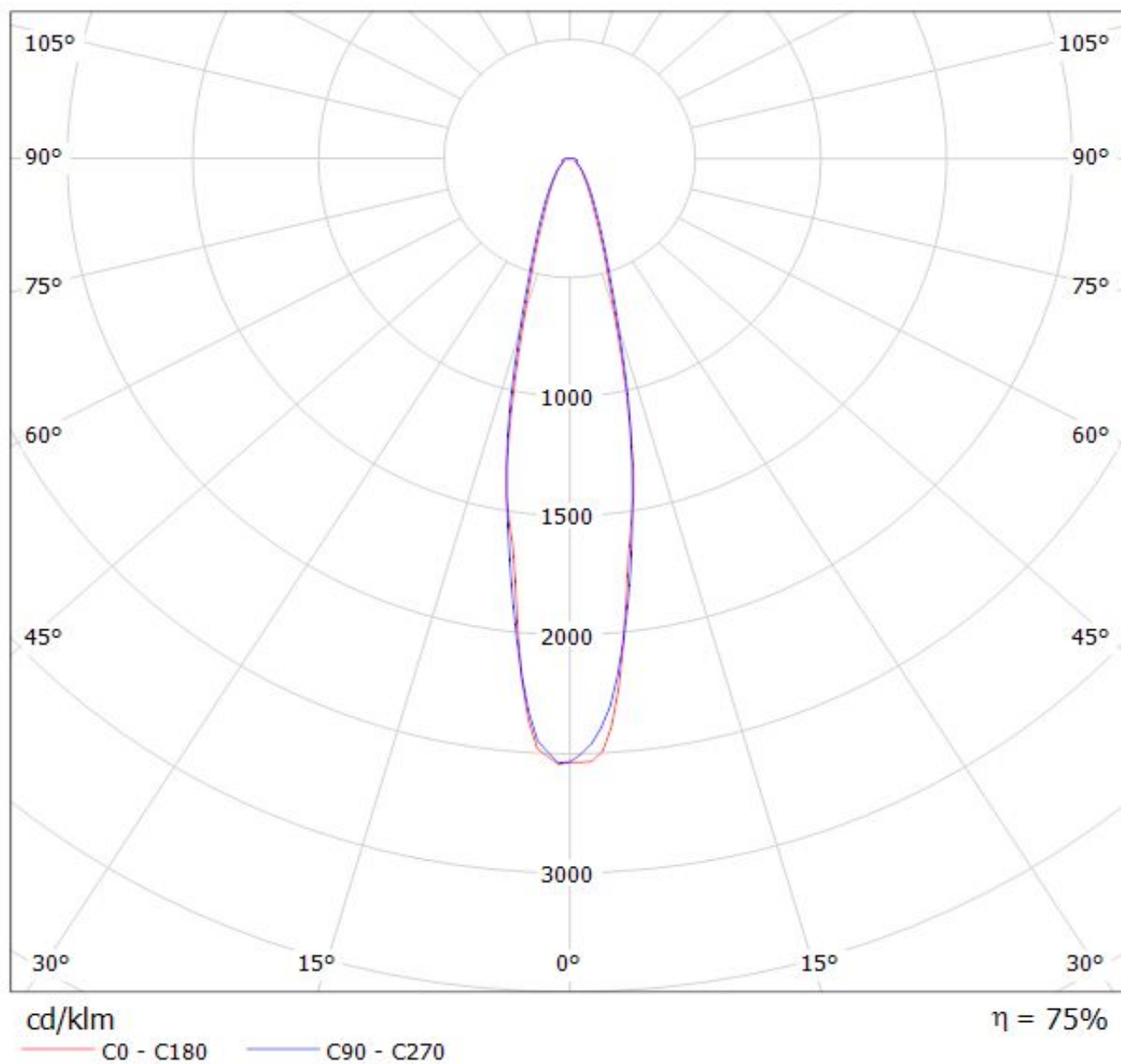

NOTE: The typical divergence will be changed by different color, chip size and chip position tolerance. The typical total divergence is the full angle measured where the luminous intensity is half of the peak value.

GENERAL INFORMATION

- Product series especially designed & optimized for series of LEDs.
- Special care taken to make light distribution as uniform as possible.

Note! Due to use of high power COB's with this product, special attention to proper thermal design is highly recommended. LEDiL has no liability for direct, indirect or consecutive damages arising from the LEDiL products being used outside of the recommended temperature range.